

ENGLISH - EN

# Instructions for use

# CLICK & FIX<sup>®</sup>

# Abutments

Reference: IFUCLICK  
Revision: Rev.03 (06/2023)

phibo<sup>φ</sup>

## SYMBOL

## LEGEND



Phibo Dental Solutions, S.L.  
P.I. Mas d'en Cisa | Gato Perez 3-9 | 08181 | Sentmenat | Barcelona | Spain



CE 0123 represents certification by TUV SUD.

0123

### 1. PURPOSE

The function of CLICK & FIX® Abutments is to serve as an intermediate structural element between the implant and the permanent prosthesis. CLICK & FIX® Abutments will be used for removable multiple prosthetic reconstructions for PHIBO® implant systems.

The purpose of the Retention Insert Kit is to provide different levels of retention and angulation of the removable structure on the abutments.

### 2. ALTERNATIVES AND REFERENCES

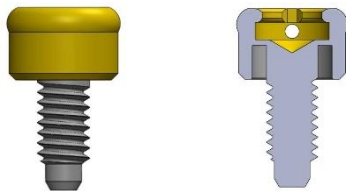

Fig. 1. CLICK & FIX® Abutment for TSH®

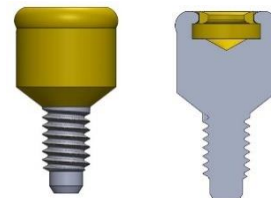

Fig. 2. CLICK & FIX® Abutment for TSA®

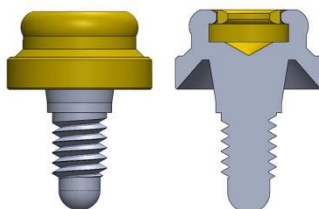

Fig. 3. CLICK & FIX® Abutment for AUREA EVO

<b>1916 C</b>	CLICK & FIX Abutment for TSH - BNT S2 1.0 mm
<b>1917 C</b>	CLICK & FIX Abutment for TSH - BNT S2 2.0 mm
<b>1918 C</b>	CLICK & FIX Abutment for TSH - BNT S2 3.0 mm
<b>1919 C</b>	CLICK & FIX Abutment for TSH - BNT S2 4.0 mm
<b>1920 C</b>	CLICK & FIX Abutment for TSH - BNT S2 5.0 mm
<b>1942 C</b>	CLICK & FIX Abutment for TSH - BNT S3/S4 1.0 mm
<b>1943 C</b>	CLICK & FIX Abutment for TSH - BNT S3/S4 2.0 mm
<b>1944 C</b>	CLICK & FIX Abutment for TSH - BNT S3/S4 3.0 mm
<b>1945 C</b>	CLICK & FIX Abutment for TSH - BNT S3/S4 4.0 mm
<b>1946 C</b>	CLICK & FIX Abutment for TSH - BNT S3/S4 5.0 mm
<b>1922 C</b>	CLICK & FIX Abutment for TSH - BNT S5 2.0 mm
<b>1923 C</b>	CLICK & FIX Abutment for TSH - BNT S5 3.0 mm
<b>1755 C</b>	CLICK & FIX Abutment for TSA – TSA Advance S3 1.0mm
<b>1756 C</b>	CLICK & FIX Abutment for TSA – TSA Advance S3 2.0mm
<b>1757 C</b>	CLICK & FIX Abutment for TSA – TSA Advance S3 3.0mm
<b>1758 C</b>	CLICK & FIX Abutment for TSA – TSA Advance S3 4.0mm
<b>1759 C</b>	CLICK & FIX Abutment for TSA – TSA Advance S3 5.0mm
<b>1761 C</b>	CLICK & FIX Abutment for TSA – TSA Advance S4 1.4mm
<b>1762 C</b>	CLICK & FIX Abutment for TSA – TSA Advance S4 2.0mm
<b>1763 C</b>	CLICK & FIX Abutment for TSA – TSA Advance S4 3.0mm
<b>1764 C</b>	CLICK & FIX Abutment for TSA – TSA Advance S4 4.0mm
<b>1765 C</b>	CLICK & FIX Abutment for TSA – TSA Advance S4 5.0mm
<b>1767 C</b>	CLICK & FIX Abutment for TSA – TSA Advance S5 2.0mm
<b>2017 C</b>	CLICK & FIX Abutment for AUREA EVO NP 2.0mm
<b>2018 C</b>	CLICK & FIX Abutment for AUREA EVO NP 3.0mm
<b>2019 C</b>	CLICK & FIX Abutment for AUREA EVO NP 4.0mm
<b>2020 C</b>	CLICK & FIX Abutment for AUREA EVO NP 5.0mm
<b>2023 C</b>	CLICK & FIX Abutment for AUREA EVO RP 2.0mm
<b>2024 C</b>	CLICK & FIX Abutment for AUREA EVO RP 3.0mm
<b>2025 C</b>	CLICK & FIX Abutment for AUREA EVO RP 4.0mm
<b>2026 C</b>	CLICK & FIX Abutment for AUREA EVO RP 5.0mm
<b>8519 C</b>	CLICK & FIX Retention Kit (1 unit)

Table 1. CLICK & FIX® Commercial References

CLICK & FIX® Abutments have different heights (as indicated in table 1) to provide greater transmucosal versatility in their use.

The Retention Kit consists of a titanium metal sleeve, a silicone spacer and nylon retentions. To facilitate the choice of retentions, there are different colors that identify the different retention forces.

<b>Inserts</b>					
<b>Forces</b>	X Light	Light	Medium	Strong	X Strong
<b>Degrees</b>	0°-20°	0°-20°	0°-10°	0°-10°	0°-10°

Fig. 4. CLICK & FIX® Retention Kit.

### 3. MATERIAL

CLICK & FIX® Abutments are made of grade 5 Titanium (Ti 6Al-4V) and have a selective titanium nitride coating (PVD-TiN). The sleeve of the retention kit is made of titanium, the retentions are made of nylon, and the spacer is made of silicone.

### 4. INDICATIONS AND CONTRAINDICATIONS

The CLICK & FIX® abutment system is designed for use with overdentures or partial dentures, retained totally or partially by endosseous implants in the mandible or maxilla.

The self-positioning design allows the patient to easily place their overdenture without the need for exact alignment of anchoring components.

The pivoting design of CLICK & FIX® retentions offers an elastic connection for the prosthesis without any loss of retention. The nylon male retention remains completely in contact with the abutment socket, while the titanium cap of the overdenture can perform a full rotational movement on the male retention. In this way the overdenture has fixed retention points and its movements and friction are largely minimized, providing great comfort to the patient.

The CLICK & FIX® abutment system is not suitable where a rigid connection is needed. It is not recommended for use in a single implant with divergence greater than 20 degrees.

CLICK & FIX® abutments: The reuse of CLICK & FIX® abutments is not allowed because it could contain accumulated contaminants and the consequent wear of the retention bands with inadequate function, and the resulting loss of retention of the prosthesis.

CLICK & FIX® retentions: The reuse of CLICK & FIX® nylon retentions may cause loss of retention of the overdenture due to wear from previous use or damage caused during removal with the instruments.

## **5. CLEANING, DISINFECTION AND STERILIZATION**

All components and instruments are supplied UNSTERILIZED.

Prosthetic components and instruments for use in the mouth must be cleaned, disinfected and sterilized prior to use, according to the process described in the document "Cleaning, Disinfection and Sterilization of Prosthetic Components and Instruments" PROSPLD.

**IMPORTANT:** Do not sterilize plastic products in autoclave, it is recommended to disinfect cold with a disinfectant suitable for dental material.

## **6. IMPLANT ABUTMENT PLACEMENT**

1. To select the appropriate abutment, determine the type and diameter of the implant being used. Then measure the thickness of the tissue from the coronal edge of the implant body to the gum crest on the highest side of the implant location. Select the corresponding soft tissue height for the abutment so that it is exactly the same as the tissue measurement, or the next highest available measurement. The exact soft tissue height for the abutment will provide the appropriate 1.5 mm of working anchorage above the level of the surrounding gum (which should not be below the tissue).

2. After the secondary gum healing period is complete, remove the healing cap according to the

instructions provided by the manufacturer of the implant system being used.

3. It is very important to remove all bone and soft tissue from the upper side of the implant body to ensure complete insertion of the implant abutment.
4. The special abutment driver is designed to fit into the inner diameter of the abutment and screw it onto the implant.
5. A final tightening of the abutment should be made at 30Ncm to prevent it from unscrewing.

NOTE: Torque wrench driver tip is available.

Remember that the 1.25 mm hex tip driver fits on the back of the abutment driver

## **7. PLACEMENT OF RETENTION INSERTS**

1. Use the retention removal tip to remove nylon retentions from the metal sleeve of the denture. The sharp circular edge at the end of the extraction tool should be inserted forcefully to the base of the male retention, so that it engages its inner part and pulls it at an angle outside the metal housing. To release the nylon retention from the extraction tip, place it with the tip down and away from you, and adjust the retention extraction tool back to the main attachment, rotating clockwise. This will activate the extraction pin and release the wrench tip.
2. The retention extraction tool is used to place the retention on the empty metal sheath of the denture, pressing firmly.  
  
The retention must be securely seated in place, at the same level as the edge of the metal sleeve.

## **8. PATIENT CARE**

For the success of the CLICK & FIX® Abutment system, good oral hygiene is essential. CLICK & FIX® abutments must be carefully cleaned every day to avoid wear caused by abrasive plate buildup. Patients should be taught to use a soft nylon brush and floss to care for the abutments. It is recommended to use a non-abrasive gel toothpaste and an irrigation system to keep the retention insert cavity clean.

In Clinic use plastic instruments to remove tartar from the abutments. Do not use metal

instruments that can scratch the surface of the abutment. Use a 30 N-cm torque wrench to make sure the abutment is firm before you finish the consultation.